

# **MAXAIR™**

## *Fume Arms*



- *No internal adjustment*
- *Smooth tubes, low static pressure*
- *Air volume damper included*
- *Self-locking joints*
- *2 grab handles*
- *Hood diverter increases capture velocity*
- *Cast aluminum joints*
- *5 different diameters*
- *5 different tube materials*



***Superior technology generating substantial operating savings***

# MAXAIR™

*High-Productivity Innovative Products*

## MAXAIR *Articulated fume extractor arm*

Overhead canopies are a thing of the past. Workers were actually breathing the dust and smoke-filled air as it was travelling upward toward the canopy. Source capture is the safe and the right way to eliminate the harmful significantly that are the primary cause of lung diseases. Maxair fume arms are built to reduce the presence of industrial indoor air particles. From laboratories right up to the large welding shops, Maxair fume arms will get the job done.



## *A Leading-Edge, High-Performance Company*

The AQC Dust Collecting Systems division manufactures a full range of safe, industrial dust collectors, as well as dust and smoke capture equipment at the leading edge of air pollution control technologies based on more than 30 years' experience in the field.

*AQC's strength lies in its innovative products designed and developed to generate substantial savings throughout their entire operating life.*

AQC is renowned for its technological innovation, safe and sophisticated equipment design, as well as its robust and precise product manufacturing. For example, the unique design of the baffles inside AQC dust collectors makes filter cleaning easy. The AQC cartridge holder design provides maximum filter surface and enhanced filter performance. The ultra-smooth concept inside AQC fume arms makes them maintenance-free.

In short, AQC equipment is designed and built to generate substantial operating savings in terms of time, money and energy. This translates to major reductions in operating costs – from 10 to 20% – throughout the equipment's service life. This scale of savings can represent a significant portion of the equipment's total purchase price. Companies looking to maximize their profitability should factor in these savings when purchasing equipment.

*The unique design and manufacturing of AQC equipment generates significant savings for various reasons:*

- Substantial increase in the duration of filters.
- Lower energy consumption during years of use.
- Significantly less maintenance (easy to clean, robust manufacturing, a minimum number of more reliable and durable parts).
- Reduced operating costs (less frequent overhauls, lack of or minimum down time, etc.).
- Lower administrative costs (coordination, follow-ups, supervision) due to much less frequent breakdowns.
- Safe design can prevent serious or even fatal accidents.
- Increased comfort and productivity of personnel.

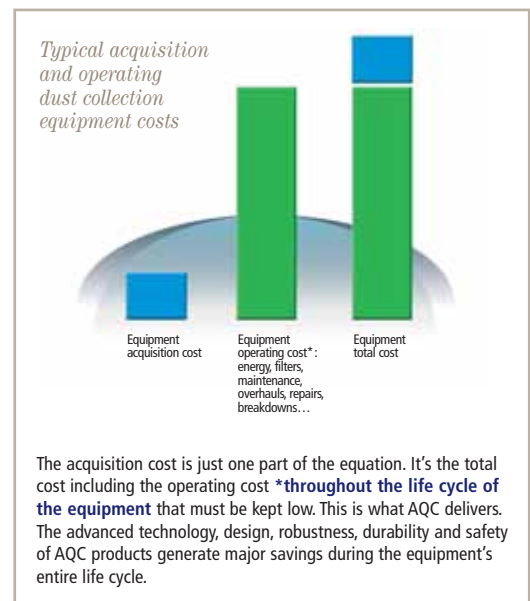

**MAXAIR™ A FULL LINE OF ARTICULATED FUME EXTRACTOR ARMS**

*Efficient, robust and easy to handle*

*Most of our competitors do not include these standard features:*

- Highly functional design facilitates fume arm handling and ease of movement.
- All supports and articulation joints are outside of the fume arm. The inside is smooth, without any obstacles that could reduce air flow, accumulate deposits and increase internal friction, which consume energy unnecessarily.
- External supports and articulation joints are readily accessible, easy to adjust and require no maintenance.
- Air diverter in hood significantly increases dust and smoke capture velocity.
- The unique design of the robust and durable central pivot made of steel makes 360° rotation easy.
- The Maxair steel tube fume arm is far more spark-resistant than constructions with a flexible hose.
- All Maxair arms are delivered pre-assembled and adjusted, ready for rapid installation and operation.

**THE MAXAIR FUME EXTRACTOR ARM HAS ARRIVED...**

**MULTI-APPLICATION EQUIPMENT**

- Welding • Gouging • Dusts • Cutting • Grinding
- Fumes • Extrusion lines • Gases



**TYPICAL APPLICATIONS FOR THE MAXAIR FUME ARMS**



**3" [75MM] AND 4" [100MM]**

- Laboratories
- Research facilities
- Beauty parlors
- Small dust applications
- Museums
- Soldering
- Light welding

*3" arms available in 3' [1 m] and 5' [1.5 m] models*

*4" arms available in 5' [1.5 m], 7' [2 m] and 8' [2.5 m] models*

**5" [125MM]**

**6" [160MM]**

**8" [200MM]**

- Medium to heavy welding
- Heavy smoke
- Plasma cutting
- Grinding and sanding
- Foundries
- Large dusts applications
- Gouging

*These arms are available in 7' [2m], 10' [3m] and 14' [4m] lengths*



**STAINLESS STEEL ARMS (ALL DIAMETERS AND ALL LENGTHS) SPECIALLY DESIGNED FOR:**

- Pharmaceutical • Food processing
- Caustics • Corrosive gases
- Solvent fumes • Laboratories
- High temperature • High humidity
- Aggressive applications
- F.D.A. hose available

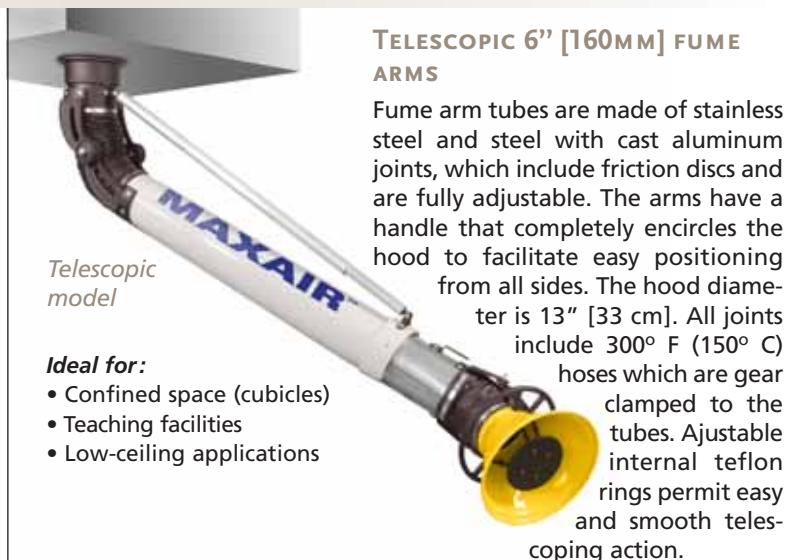

**TELESCOPIC 6" [160MM] FUME ARMS**

Fume arm tubes are made of stainless steel and steel with cast aluminum joints, which include friction discs and are fully adjustable. The arms have a handle that completely encircles the hood to facilitate easy positioning from all sides. The hood diameter is 13" [33 cm]. All joints include 300° F (150° C) hoses which are gear clamped to the tubes. Adjustable internal teflon rings permit easy and smooth telescoping action.

**Ideal for:**

- Confined space (cubicles)
- Teaching facilities
- Low-ceiling applications

## OUTSTANDING MAXAIR STANDARD FEATURES



*Note: To assure proper installation, refer to local building laws and requirements. Support structure has to meet sturdiness and reliability for weight and torque of fume arm and equipment.*

## GENERAL DESCRIPTION

Standard fume arm tubes are made of steel with external cast aluminum joints, which include friction discs and are fully adjustable. The arms have a handle that completely encircles the hood to facilitate easy positioning. Aluminum hood diameters vary from 6" on the 3" arms, to 13" on the 6" and the 8" arms. Please refer to the chart on page 5. All joints include a 300 °F (150 °C) hoses, which are gear clamped to the tubes. All hoods may be fitted with an optional light kit. The hood diverter (except on 3" arms) increases capture velocity. Fan start/stop switches may also be installed on fume hoods.

MAXAIR self-locking arms can be combined with several accessories to provide the best solution to specific problems.

A large variety of hoods can be manufactured to suit particular requirements. Tubes are also available in PVC, aluminum, 304 stainless steel (luster finish) or 316 stainless steel (non-luster).

## MODEL NUMBERS

### HANGING AND TABLE/BENCH MOUNT

**CHART 1**

Hanging	Bench mount	Stainless steel hanging	Stainless steel bench mount	Arm diameter [inches] / [mm]	Arm length [feet] / [m]	Standard hood diameter [inches] / [mm]	Optional hood diameter [inches] / [mm]	Weight [lbs] / [kg]
FA-HPG3-03	FA-PPG3-03	FA-HSS3-03	FA-PSS3-03	3 / 75	3 / 1.0	6 / 160	6 / 160	14 / 6.3
FA-HPG3-05	FA-PPG3-05	FA-HSS3-05	FA-PSS3-03	3 / 75	5 / 1.5	6 / 160	6 / 160	16 / 7.2
FA-HPG4-05	FA-PPG4-05	FA-HSS4-05	FA-PSS4-05	4 / 100	5 / 1.5	8 / 200	8 / 200	17 / 7.7
FA-HPG4-07	FA-PPG4-07	FA-HSS4-07	FA-PSS4-07	4 / 100	7 / 2.0	8 / 200	8 / 200	19 / 8.6
FA-HPG4-08	FA-PPG4-08	FA-HSS4-08	FA-PSS4-08	4 / 100	8.5 / 2.5	8 / 200	8 / 200	22 / 10
FA-HPG5-07	FA-PPG5-07	FA-HSS5-07	FA-PSS5-07	5 / 125	7 / 2.0	10 / 250	16 / 400	38 / 17.2
FA-HPG5-10	FA-PPG5-10	FA-HSS5-10	FA-PSS5-10	5 / 125	10 / 3.0	10 / 250	16 / 400	43 / 19.5
FA-HPG5-14	FA-PPG5-14	FA-HSS5-14	FA-PSS5-14	5 / 125	14 / 4.0	10 / 250	16 / 400	47 / 21.3
FA-HPG6-07	FA-PPG6-07	FA-HSS6-07	FA-PSS6-07	6 / 160	7 / 2.0	13 / 315	20 / 500	44 / 20
FA-HPG6-10	FA-PPG6-10	FA-HSS6-10	FA-PSS6-10	6 / 160	10 / 3.0	13 / 315	20 / 500	52 / 23.5
FA-HPG6-14	FA-PPG6-14	FA-HSS6-14	FA-PSS6-14	6 / 160	14 / 4.0	13 / 315	20 / 500	60 / 27.2
FA-HPG8-07	FA-PPG8-07	FA-HSS8-07	FA-PSS8-07	8 / 200	7 / 2.0	13 / 315	20 / 500	57 / 26
FA-HPG8-10	FA-PPG8-10	FA-HSS8-10	FA-PSS8-10	8 / 200	10 / 3.0	13 / 315	20 / 500	66 / 30
FA-HPG8-14	FA-PPG8-14	FA-HSS8-14	FA-PSS8-14	8 / 200	14 / 4.0	13 / 315	20 / 500	74 / 33.5

### Telescopic fume arm 6" [160 mm] only

**CHART 2**

Model	Minimum reach [inches] / [mm]	Maximum reach [inches] / [mm]	Standard hood diameter [inches] / [mm]	Optional hood diameter [inches] / [mm]	Weight [lbs] / [kg]
FA-TPG6-05	48 / 1200	60 / 1500	13 / 315	20 / 500	45 / 20
FA-TPG6-06	48 / 1200	72 / 1800	13 / 315	20 / 500	52 / 24
FA-TPG6-08	72 / 1800	96 / 2400	13 / 315	20 / 500	68 / 31

### Recommended air flow

**CHART 3**

Arm diameter [inches] / [mm]	CFM	M <sup>3</sup> /Hr
3 / 75	100 / 150	170 / 255
4 / 100	125 / 200	210 / 340
5 / 125	350 / 500	600 / 850
6 / 160	500 / 750	850 / 1275
8 / 200	800 / 1000	1350 / 1700

### Recommended fan selection

**CHART 4**

Arm diameter [inches] / [mm]	Fan model	HP / KW
3 / 75	DFR-8	0.33/0.25
4 / 100	DFR-9	0.33/0.25
5 / 125	DFR-11	1/0.75
6 / 160	DF-01	1/0.75
8 / 200	DF-02	2/1.50

## MAXIDRIVE FANS (3450 R.P.M.)

Backward inclined (recommended for 6" and 8" diameter arms [160mm and 200mm])

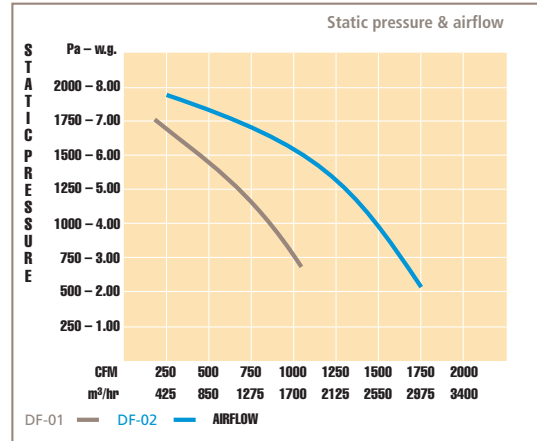
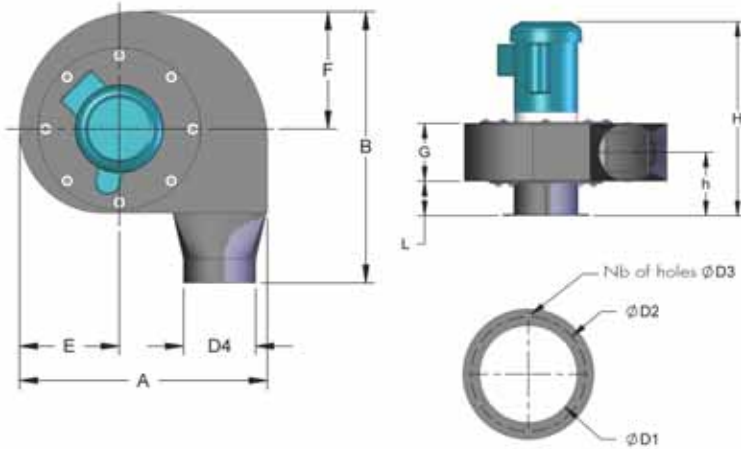

### Fan dimensions

CHART 5

Model	Power [HP]	Dimension [inches] / [mm]											Weight [lbs] / [kg]		
		A	B	E	F	H	L	G	h	d1	d2	d3		d4	n
DF-01	1 / 0.75	20.2 / 513	22.6 / 574	8.3 / 211	9.8 / 249	21.1 / 536	3.9 / 99	5.9 / 150	6.9 / 175	6.25 / 160	7.69 / 195	0.4 / 9	6 / 198	6	70 / 31.8
DF-02	2 / 1.50	22.7 / 577	24.8 / 630	9.2 / 234	11 / 279	24.8 / 630	4.9 / 124	6.3 / 160	7.4 / 188	8 / 200	9.69 / 246	0.4 / 9	8 / 249	8	82 / 37.3

Electrical note: Motors are available in all voltages. Specify on order.

Technical note: Refer to Maxidrive fan leaflet for complete data.

Recommended fans above are designed for arrangement as shown on page 9 of this leaflet.

Radial blade (recommended for 3", 4" and 5" diameter arms [75mm, 100mm and 125mm])

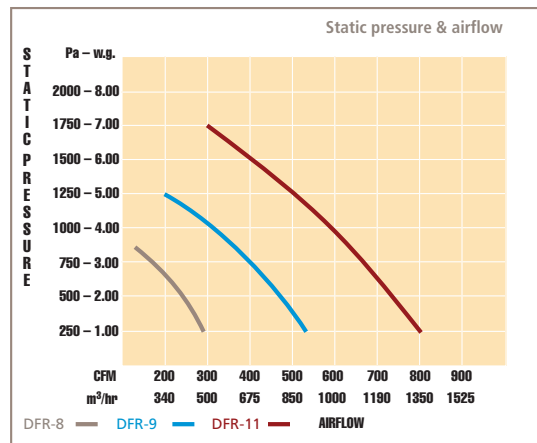
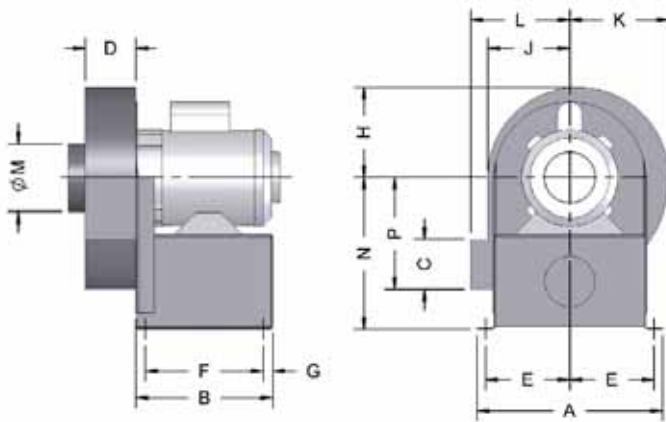

### Fan dimensions

CHART 6

Model	[HP] / [KW]	Dimension [inches] / [mm]													Weight [lbs] / [kg]	
		A	B	C	D	E	F	G	H	J	K	L	M	N		P
DFR-8	0.33 / 0.25	11 / 279	8 / 203	8 / 203	3 / 76	5 / 127	7 / 178	0.5 / 13	5.38 / 137	4.88 / 124	5.88 / 149	5.88 / 149	4 / 102	6.63 / 168	9 / 229	44 / 20
DFR-9	0.33 / 0.25	12.13 / 308	8 / 203	3.5 / 89	3.5 / 89	5.63 / 143	7 / 178	0.5 / 13	6.38 / 162	5.75 / 146	6.88 / 175	6.75 / 171	5 / 127	7.5 / 191	9.88 / 251	46 / 21
DFR-11	1 / 0.75	14.75 / 375	9 / 229	4 / 102	3.5 / 89	6.88 / 175	7.5 / 191	0.75 / 19	7.25 / 184	6.5 / 165	8 / 203	7.63 / 194	6 / 152	8.63 / 219	11.75 / 298	62 / 28

Electrical note: Motors are available in all voltages. Specify on order.

Recommended fans above are designed for arrangement as shown on page 9 of this leaflet.

## MAXAIR FUME ARM WALL AND BENCH MOUNTING BRACKET

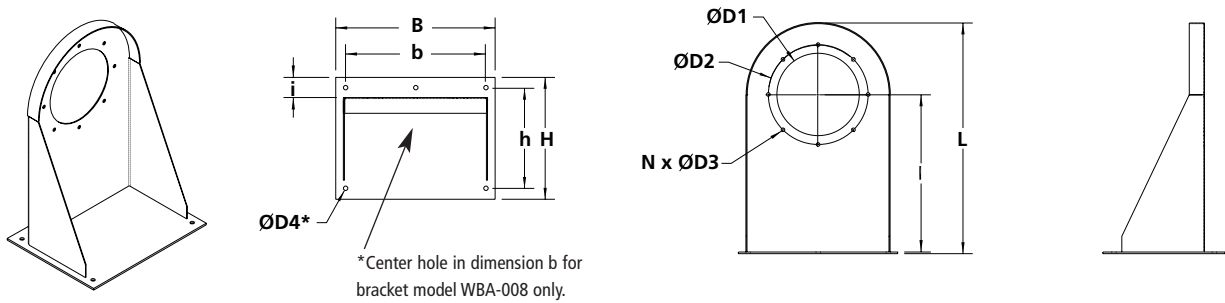

Bracket shown below must be ordered separately. Both arm models (hanging and bench mount ) can be mounted on the bracket shown above.

### Arm bracket dimension

CHART 7

Bracket type		Dimension [inches] / [mm]													Weight [lbs] / [kg]
Painted steel	Stainless steel	Arm Diameter [feet] / [mm]	D1	D2	N	D3	D4	L	l	H	h	B	b	i	
WBA-003	WBA-SS3	3 / 75	3.00 / 160	4.38 / 111	4	0.28 / 7	0.33 / 8	6.69 / 170	3.83 / 97	3.94 / 100	2.75 / 70	5.43 / 138	4.25 / 108	-	1 / 0.45
WBA-004	WBA-SS4	4 / 100	3.94 / 200	5.28 / 134	4	0.28 / 7	0.33 / 8	7.48 / 190	3.94 / 100	3.94 / 100	2.75 / 70	6.25 / 159	5.13 / 130	-	1 / 0.45
WBA-005	WBA-SS5	5 / 125	5.00 / 127	6.50 / 165	6	0.28 / 7	0.43 / 11	9.88 / 251	5.75 / 146	6.38 / 162	5.19 / 132	9.50 / 241	7.94 / 202	1.25 / 32	5 / 2.3
WBA-006	WBA-SS6	6 / 160	6.25 / 160	7.69 / 195	6	0.28 / 7	0.43 / 11	14.71 / 374	9.81 / 249	6.50 / 165	5.31 / 135	9.84 / 250	7.87 / 200	1.38 / 35	8 / 3.6
WBA-008	WBA-SS8	8 / 200	8.00 / 200	9.69 / 246	8	0.35 / 9	0.43 / 11	18.80 / 478	12.75 / 324	9.88 / 251	8.25 / 210	13.00 / 330	11.44 / 291	1.56 / 40	14 / 6.3

## MAXIDRIVE — FAN SUPPORT BRACKET DIMENSIONS

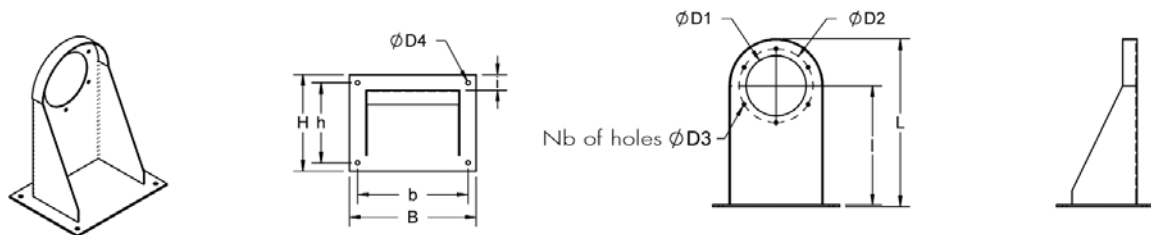

Bracket shown below must be ordered separately. Both models (hanging and bench mount ) can be mounted on the bracket.

### Fan support bracket dimensions

CHART 8

Model	[HP] / [KW]	Dimension [inches] / [mm]													Weight [lbs] / [kg]
		D1	D2	N	D3	D4	L	l	H	h	B	b	i		
WBF-006	1 / 0.75	6.25 / 160	7.69 / 195	6	0.28 / 7	0.43 / 11	17.44 / 443	12.38 / 314	10 / 254	8.31 / 211	13.19 / 335	11.5 / 292	1.75 / 44	11 / 5	
WBF-008	2 / 1.50	8 / 200	9.69 / 246	8	0.35 / 9	0.43 / 11	22.44 / 570	15.25 / 387	11.88 / 302	9.75 / 248	15.5 / 394	13.63 / 346	2 / 51	13 / 5.9	

## MAXAIR MAXIMUM REACH FOR HANGING/BENCH MOUNT MODELS

MAXAIR — hanging model

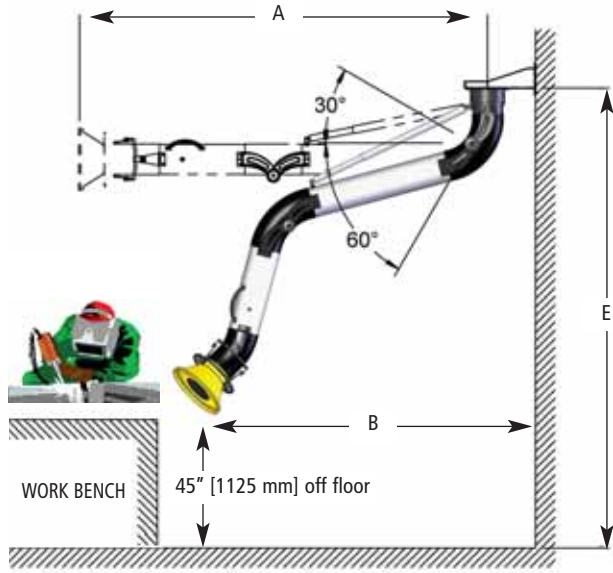

MAXAIR — Table/bench mount model

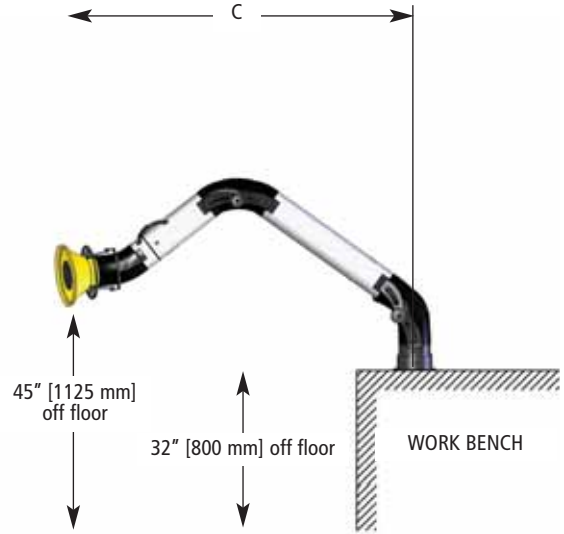
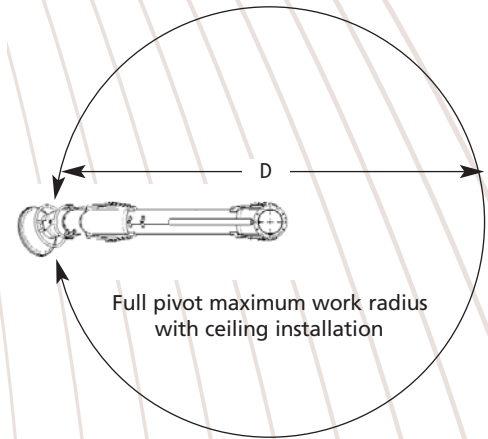
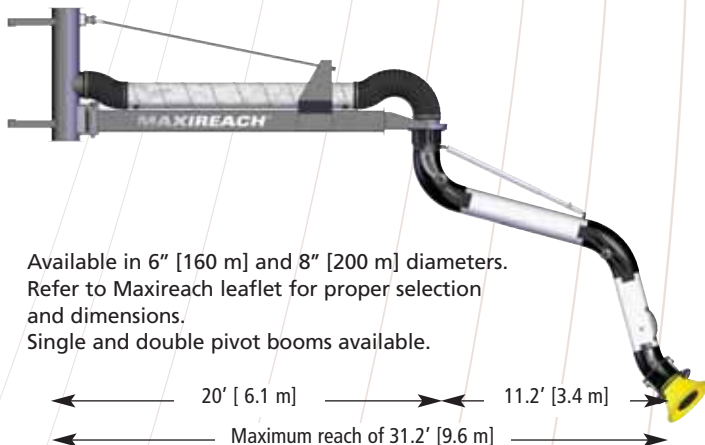

CHART 9

A Arm length [feet] / [m]	B Maximum reach at 45" off floor [feet] / [m]	C Maximum reach at 45" off floor [feet] / [m]	D Maximum reach at 45" off floor [feet] / [m]	E Recommended mounting height [feet] / [m]
3 / 0.9	2.6 / 0.7	3 / 0.9	5.2 / 1.4	5 / 1.5
5 / 1.5	3.5 / 1.1	5 / 1.5	7 / 2.2	6 / 1.8
7 / 2.1	5.5 / 1.7	7 / 2.1	11 / 3.4	6.5 / 2
8.5 / 2.6	7.4 / 2.2	8.5 / 2.6	14.8 / 4.4	7 / 2.1
10 / 3	8.5 / 2.6	8.5 / 2.6	17 / 5.2	9 / 2.7
14 / 4	11.2 / 3.4	11.4 / 3.5	22.4 / 6.8	10 / 3



## MAXAIR MAXIMUM REACH WITH MAXIREACH EXTENSION BOOMS



Available in 6" [160 mm] and 8" [200 mm] diameters.  
Refer to Maxireach leaflet for proper selection  
and dimensions.  
Single and double pivot booms available.

*Source capture  
has never been  
so easy...  
and efficient*



**MAXAIR SINGLE FUME ARM AND FAN ARRANGEMENT**



Available in all diameters

*Typical installation of source capture arm for exhaust*

**MAXAIR FUME ARM AND MAXIREACH EXTENSION BOOM ARRANGEMENT**



Available in 6" [160mm] and 8" [200mm] diameters. Refer to Maxireach leaflet for proper selection.

*Typical installation of source capture arm with extended reach*

**MAXAIR FUME ARM AND MAXIRAIL DUCT/TROLLEY SYSTEM**

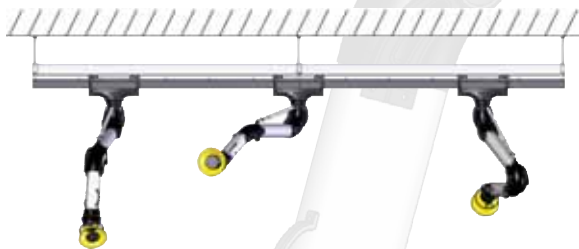

Available for 3' [75mm], 4" [100mm], 5" [125mm] and 6" [160mm] arms.

*Typical installation of source capture arms with sliding trolley*

**MAXAIR FUME ARM WITH MAXIFLO DUST COLLECTOR ARRANGEMENT**



Note: Refer to arm diameter chart # 3 for recommended air flow. Refer to Maxiflo leaflet for proper dust collector selection.

*Typical installation of source capture arms and filtration*

## 24 VOLTS – 35 WATTS HALOGEN LIGHT KIT MOUNTING MODELS

Light kit model (only) 7122L

Fan switch (only) model 7122F

Light and fan switch model 7122LF



Note: Diverter and light kit assembly not available on 3" arms. Fan start/stop switch available.

Available starters with transformers for light kits and fan switches

Models	Electrical
CB 115/1/60	Digits shown indicate voltage/phases/cycle When ordered, specify if arms are equipped with light kits and/or fan switches. If such equipped, starters will be supplied with low voltage transformers.
CB 230/1/60	
CB 208/3/60	
CB 460/3/60	
CB 575/3/60	

Note: When ordered in conjunction with Maxair fume arms, light kits and fan control switches will be factory installed. If ordered after arms are delivered, retrofit air diverters and assembly instructions will be supplied.

## MAXAIR FUME ARM EXTENSIONS AND FLOOR POSTS

### Vertical floor posts



Models	Height [feet] / [m]	
VFP-07	7/2.15	For arms 7' / 2.15 [m] long and less
VFP-08	8 / 2.6	For arms 8.5' & 10' / 2.7 & 3' [m] long
VFP-11	11 / 3.4	For arms 14' / 4.3 [m] long

When ordered add suffix digits according to arm diameter  
ex: VFP-08-06 indicates for 6" diameter arm

### Ceiling support extensions



Models	Height [feet] / [m]
CSE-30	30
CSE-36	36
CSE-42	42

When ordered add suffix digits according to arm diameter  
ex: CSE-36-06 indicates for 6" diameter arm

### Horizontal fixed extensions



Models	Length [feet] / [m]
HFE-02	2 / 0.6
HFE-04	4 / 1.25

When ordered add suffix digits according to arm diameter  
ex: HFE-04-06 indicates for 6" diameter arm

Installation note: Refer to local building laws prior to installation. Support structure has to meet sturdiness and weight of equipment.

## STATIC PRESSURE & AIRFLOW

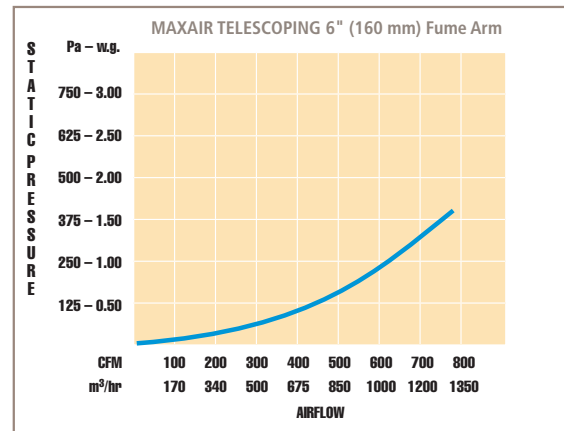
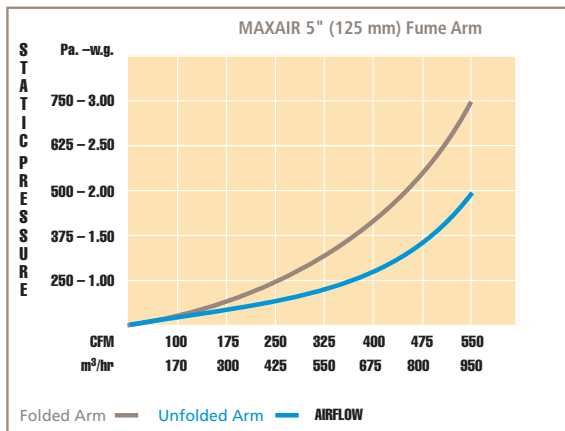
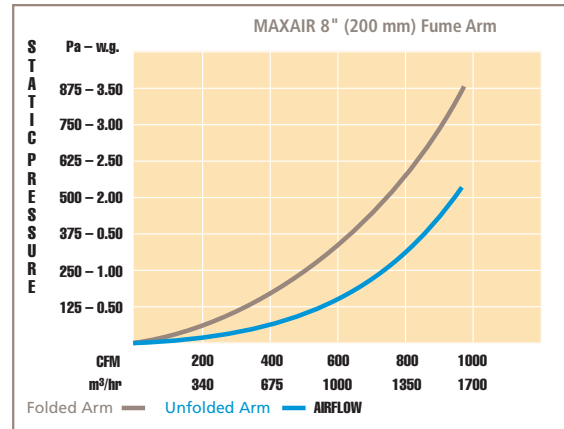
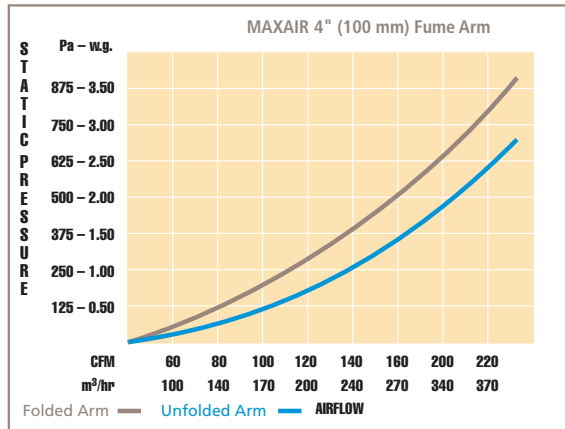
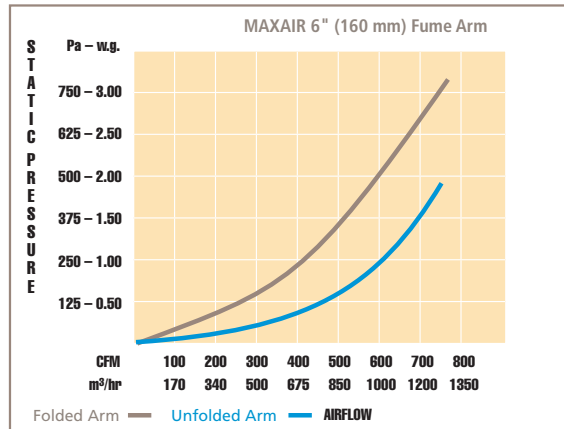
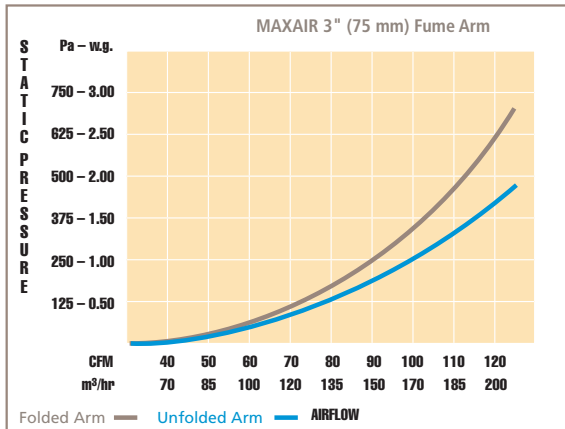

Note: MAXAIR fume arms are available in different lengths but have minimal variation in static pressure curves indicated above.

## OPTIONS

- Halogen light kits (24 V. / 35 watt)
- Fan and light control switch on the hood
- High temperature or F.D.A. hoses at joints
- Horizontal fixed extensions
- Vertical floor posts
- Ceiling support extensions
- Maxireach extension booms (up to 20' / 6m)
- Protective wire mesh in hood
- Fan mounted above arm bracket
- Larger or custom inlet hoods
- Custom colors (minimum quantities required)
- Grounding wire for static discharge on P.V.C. tubes

## CREATE YOUR MAXAIR FUME ARM SPECIFICATION

**1. FUME ARM SHOULD BE:**

- A) Hanging model
- B) Bench mount model

**2. FUME ARM SHOULD HAVE DIAMETER OF:**

- A) 3" [75mm] with 7" [175mm] hood
- B) 4" [100mm] with 8" [200mm] hood
- C) 5" [125mm] with 10" [250mm] hood
- D) 6" [160mm] with 13" [325mm] hood
- E) 8" [200mm] with 13" [325mm] hood

3" [75mm] fume arm should have length of:

- A) 3' [0.9m]
- B) 5' [1,5m]

4" [100mm] fume arm should have length of:

- A) 5' [1,5m]
- B) 7' [2,1m]
- C) 8, 5' [2,5m]

5", 6" and 8" [125, 160 and 200mm] fume arm should have length of:

- A) 7' [2m]
- B) 10' [3m]
- C) 14' [4m]

**3. FUME ARM SHOULD BE TELESCOPIC TYPE (6" ONLY):**

- A) 48" [1200mm] to 60" travel [1500mm]
- B) 48" [1200mm] to 72" travel [1800mm]
- C) 72" [1800mm] to 96" travel [2400mm]

**4. FUME ARM SHOULD HAVE EXTERIOR ADJUSTMENTS MADE OF STAMPED STEEL FOR:**

- A) 3" [75mm] arm
- B) 4" [100mm] arm

**FUME ARM SHOULD HAVE EXTERIOR ADJUSTMENTS MADE OF CAST ALUMINIUM FOR:**

- A) 5" [125mm] arm
- B) 6" [160mm] arm
- C) 8" [200mm] arm

Note: Specifications listed above may be modified to suit application. Contact A.Q.C. or representative for information.

**5. FUME ARM TUBES SHOULD BE CONSTRUCTED OF:**

- A) powder coat painted steel
- B) 304 luster finish stainless steel
- C) 316 brushed finish stainless steel
- D) P.V.C. (painted tubes)
- E) aluminum (painted or bare tubes)

**6.** Fume arm should include an air volume damper with handle on hood tube (standard) and should include an air diverter within the hood to increase inlet velocity (except on 3" arms).

**7.** Fume arm should include a circular grab handle around the hood for positioning of the arm and a secondary hood tube grab handle for 5 – 6 and 8" [125 – 160 and 200 mm] diameter arms.

**8. FUME ARM WILL BE SUPPLIED WITH:**

- A) powder coat painted steel bracket
- B) 304 stainless steel support bracket
- C) 316 stainless steel support bracket

**9. FUME ARM JOINTS WILL BE SUPPLIED WITH:**

- A) AF-1 cotton neoprene 250 °F [120 °C] hose
- B) MBSF silicone fibreglass high temperature 600 oF [315 oC] hose
- C) ET extreme temperature 1200 °F [650 °C] hose
- D) F.D.A. hose

**10.** Fume arm will be supplied with an encapsulated recoil spring for 7', 10' and 14' [2, 3 and 4 m] arms (standard).

**11. FUME ARM WILL BE SUPPLIED WITH:**

- A) halogen light kit 24 volts, 35 watts and switch model 7122L (except on 3" arms).
- B) fan control switch model 7122F
- C) halogen light kit 24 volts, 35 watts with switch and fan control switch model 7222LF (except on 3" arms).
- D) wide screen mesh in hood

**12.** Fume arm hood should have a diameter of: 20" [500mm] in lieu of standard hood for 6" [160mm] and 8" [200mm] diameter arms.

### One of kind warranty

A.Q.C. Inc. will guarantee their products against defects in material and workmanship for a period of 27 months from product ship date.

Your A.Q.C. representative is:



To obtain a free copy of our full-colour corporate brochure, please call: **1-866-629-4356**

660, de la Sabliere, Bois-des-Filion (Quebec) Canada J6Z 4T7  
 Tel.: **1-866-629-4356** • Fax: (450) 621-6677  
 Web site: [www.aqc dust.com](http://www.aqc dust.com) • e-mail: [info@aqc dust.com](mailto:info@aqc dust.com)