

AQC source capture equipment

MAXAIR™

Fume Arms



Superior technology generating substantial operating savings

A Leading-Edge, High-Performance Company

The AQC Dust Collecting Systems division manufactures a full range of safe, industrial dust collectors, as well as dust and smoke capture equipment at the leading edge of air pollution control technologies based on more than 30 years' experience in the field.

AQC's strength lies in its innovative products designed and developed to generate substantial savings throughout their entire operating life.

AQC is renowned for its technological innovation, safe and sophisticated equipment design, as well as its robust and precise product manufacturing. For example, the unique design of the baffles inside AQC dust collectors makes filter cleaning easy. The AQC cartridge holder design provides maximum filter surface and enhanced filter performance. The ultra-smooth concept inside AQC fume arms makes them maintenance-free.

In short, AQC equipment is designed and built to generate substantial operating savings in terms of time, money and energy. This translates to major reductions in operating costs – from 10 to 20% – throughout the equipment's service life. This scale of savings can represent a significant portion of the equipment's total purchase price. Companies looking to maximize their profitability should factor in these savings when purchasing equipment.

The unique design and manufacturing of AQC equipment generates significant savings for various reasons:

- Substantial increase in the duration of filters.
- Lower energy consumption during years of use.
- Significantly less maintenance (easy to clean, robust manufacturing, a minimum number of more reliable and durable parts).
- Reduced operating costs (less frequent overhauls, lack of or minimum down time, etc.).
- Lower administrative costs (coordination, follow-ups, supervision) due to much less frequent breakdowns.
- Safe design can prevent serious or even fatal accidents.
- Increased comfort and productivity of personnel.

Typical acquisition and operating dust collection equipment costs

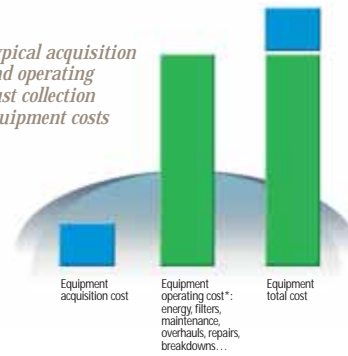

The acquisition cost is just one part of the equation. It's the total cost including the operating cost *throughout the life cycle of the equipment that must be kept low. This is what AQC delivers. The advanced technology, design, robustness, durability and safety of AQC products generate major savings during the equipment's entire life cycle.

High-Productivity Innovative Products

MAXAIR

Articulated fume extractor arm

Overhead canopies are a thing of the past. Workers were actually breathing the dust and smoke-filled air as it was travelling upward toward the canopy. Source capture is the safe and the right way to eliminate the harmful pollutants that are the primary cause of lung diseases. Maxair fume arms are built to reduce to a minimum the presence of industrial indoor air particles. From laboratories right up to the large welding shops, Maxair fume arms will get the job done.

MAXAIR™ A full line of articulated fume extractor arms
Efficient, robust and easy to handle

Most of our competitors do not include these standard features:

- Highly functional design facilitates fume arm handling and ease of movement.
- All supports and articulation joints are outside of the fume arm. The inside is smooth, without any obstacles that could reduce airflow, accumulate deposits and increase internal friction, which consume energy unnecessarily.
- External supports and articulation joints are readily accessible, easy to adjust and require no maintenance.
- Air diverter in hood significantly increases dust and smoke capture velocity.
- The unique design of the robust and durable central pivot made of steel makes 360° rotation easy.
- The Maxair steel tube fume arm is far more spark-resistant than constructions with a flexible hose.
- All Maxair arms are delivered pre-assembled and adjusted, ready for rapid installation and operation.

The Maxair fume extractor arm has arrived...

Multi-application equipment • Welding • Gouging • Dusts • Cutting • Grinding • Fumes • Extrusion lines • Gases

6" [160mm] and 8" [200mm] arms



Typical applications for the Maxair fume arms



3" [75mm] and 4" [100mm]

- Laboratories
- Research facilities
- Beauty parlors
- Small dust applications
- Museums
- Soldering
- Light welding

3" arms available in 3' (1 m) and 5' (1.5 m) models

4" arms available in 5' (1.5 m), 7' (2 m) and 8' (2.5 m) models

6" [160mm] and 8" [200mm]

- Medium to heavy welding
- Heavy smoke
- Plasma cutting
- Grinding and sanding
- Foundries
- Large dusts applications
- Gouging

These arms are available in 7' (2m), 10' (3m) and 14' (4m)



Stainless steel arms (all diameters and all lengths) specially designed for:

- Pharmaceutical • Food processing
- Caustics • Corrosive gases
- Solvent fumes • Laboratories
- High temperature • High humidity
- Aggressive applications



Telescopic 6" [160mm] fume arms

Fume arm tubes are made of stainless steel and steel with cast aluminum joints, which include friction discs and are fully adjustable. The arms have a handle that completely surrounds the hood to facilitate easy repositioning from all sides. The hood diameter is 12". All joints include a 300° F hose which is gear clamped to the tube. All hoods are equipped to receive an optional light kit.



- Ideal for:**
- Restricted space (cubicles)
 - Teaching facilities
 - Low-ceiling applications

Models	Catalog number	Minimum working range inches / [mm]	Maximum working range inches / [mm]	Arm diameter inches / [mm]	Hood diameter inches / [mm]	Weight lb / [kg]
1.	TPG-4-6	55.5"/1400	72"/1800	6"/160	12"/315	56/25.5
2.	TPG-6-8	72"/1800	96"/2500	6"/160	12"/315	60/27.5

Outstanding Maxair features



TECHNICAL DATA

CHART 1

Model	Arm diameter [inches] / [mm]	Arm reach maximum [feet] / [m]	Available hood diameter [inches] / [mm]
1	3-03	3 / 1.0	6 / 160
2	3-05	5 / 1.5	6 / 160
3	4-05	5 / 1.5	8 / 200
4	4-07	7 / 2.0	8 / 200
5	4-08	8 / 2.5	8 / 200
6	6-07	7 / 2.0	12 (14) / 315 (350)
7	6-10	10 / 3.0	12 (14) / 315 (350)
8	6-14	14 / 4.0	12 (14) / 315 (350)
9	8-07	7 / 2.0	14 (20) / 350 (500)
10	8-10	10 / 3.0	14 (20) / 350 (500)
11	8-14	14 / 4.0	14 (20) / 350 (500)

Add the letter "S" before the model number to order or specify stainless steel arms. Add the letter "P" after the model number to order or specify standing flange-mounted arms.

*Source capture
has never been so easy...
and efficient*

CHART 2

Arm diameter	Bracket model
3" (75mm)	WBA-003
4" (100mm)	WBA-004
6" (160mm)	WBA-006
8" (200mm)	WBA-008

For stainless steel brackets:
Add the letter "S" after the model number.

CHART 3

Recommended airflow	
3" arm	250 - 350 CFM
4" arm	350 - 450 CFM
6" arm	650 - 750 CFM
8" arm	800 - 900 CFM

Leading-edge construction

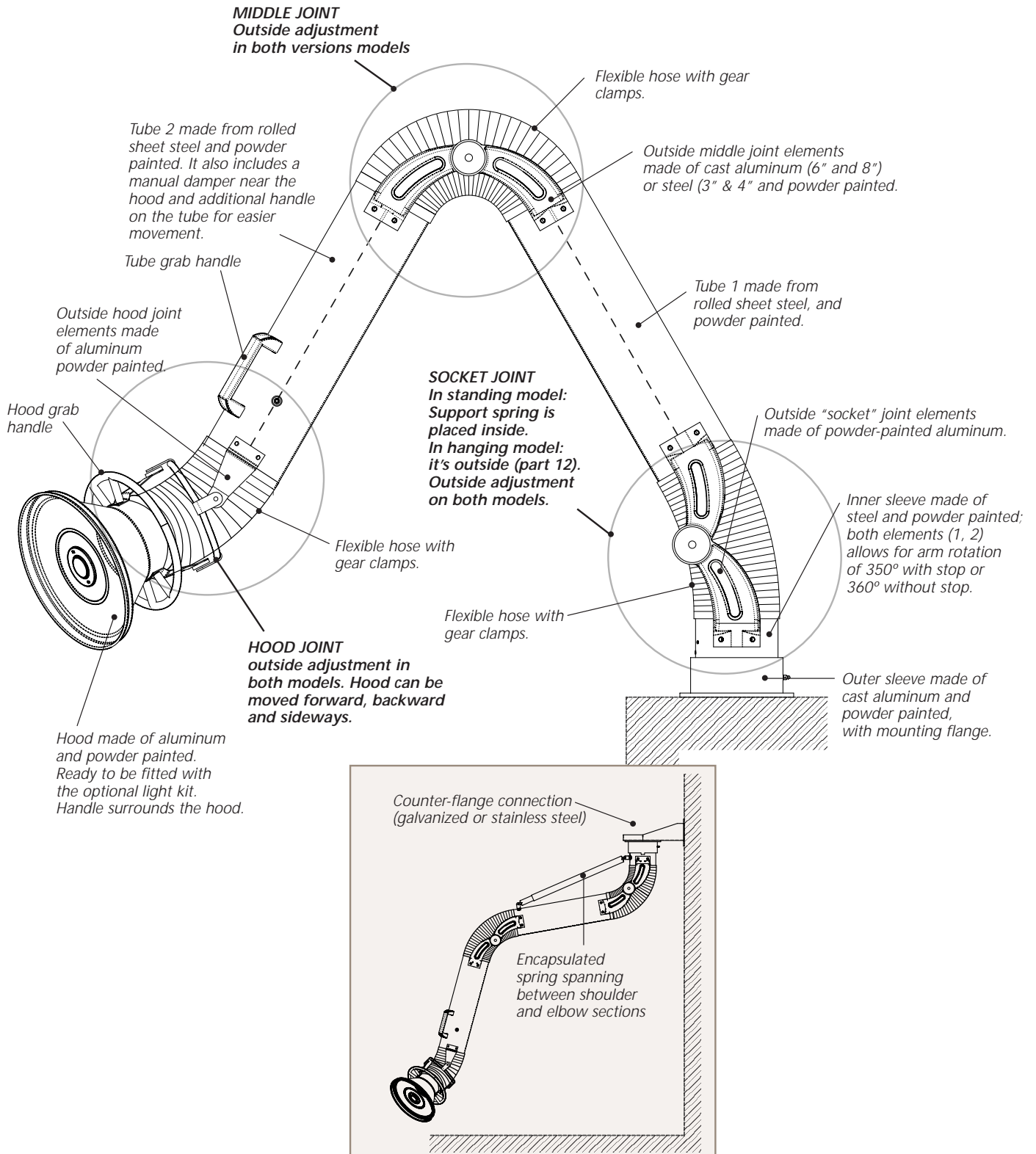

MAXAIR “self-locking arm” in 3”, 4”, 6” and 8” models

MAXAIR air “self-locking arms” provide the most economical and effective methods for capturing fumes and dusts. Contaminants are removed at the source. The self-supporting joints, flexible hoses and smooth bore tubing enable easy placement of the arm’s hood near the source.

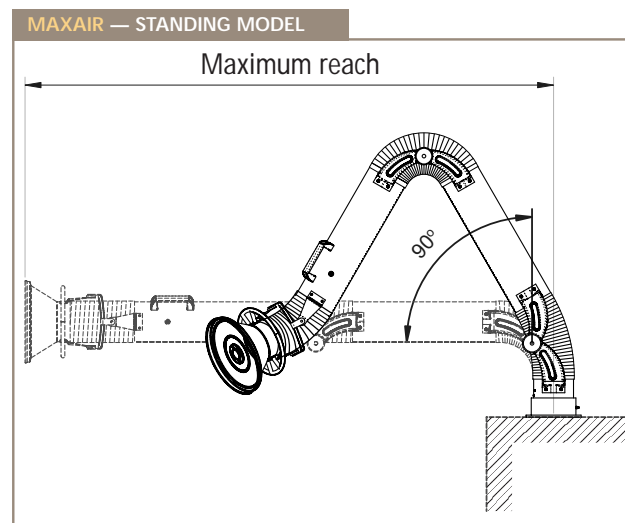
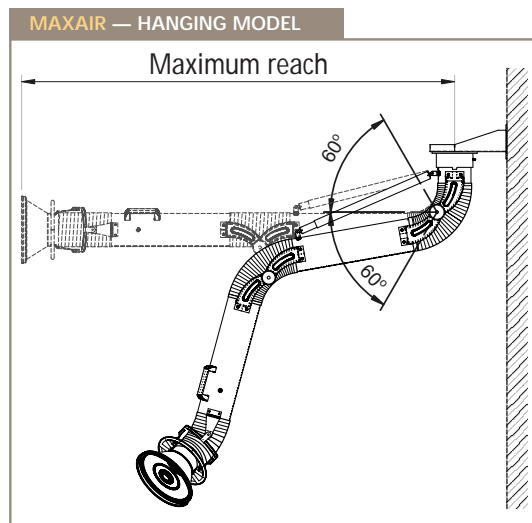

Specifications

Fume arm tubes are made of steel with cast aluminum joints, which include friction discs and are fully adjustable. The arms have a handle that completely surrounds the hood to facilitate easy repositioning from all sides. Hood diameters vary from 6" on the 3" arms, to 14" on the 8" arms. Please refer to the chart on page 4. All joints include a 300° F hose, which is gear clamped to the tube. All hoods are equipped to receive an optional light kit. The hood diverter increases capture velocity.

MAXAIR self-locking arms can be combined with several accessories to provide the best solution to specific problems:

- Pivoting extension booms can increase reach from 3 to 19.5 feet
- Arms with a standing bench-mountable flange
- Availability of fans or filtering systems

Applications

All welding processes:

- Glue fumes, grinding dust and most airborne dust
- Soldering fumes
- Chemical applications, such as laboratories (stainless steel fume arms)

A large variety of hoods can be manufactured to suit particular requirements. Different diameters and various types of metal tubes are available.

Horizontal maximum reaches indicated are calculated with installation of arm at the recommended height and use of work surface at 30" high [0.85m].

MAXIMUM REACH HANGING MODEL

3 ft [1m] arm:	2.5 [0.85m]
5 ft [1.5m] arm:	4.5 [1.4m]
7 ft [2m] arm:	6 [1.8m]
10 ft [3m] arm:	8.5 [2.6m]
14 ft [4m] arm:	11.8 [3.5m]

Standing models have full reach of their length.

Static pressure & air flow

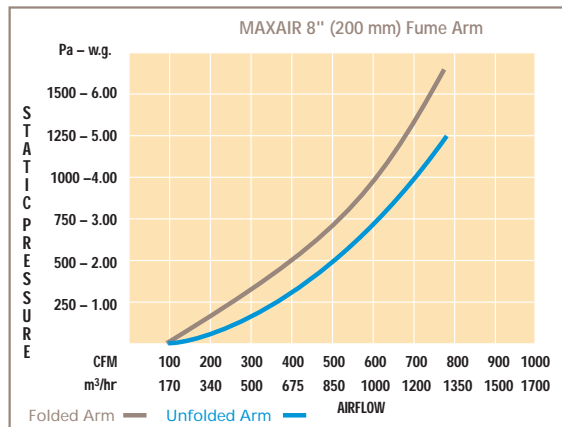
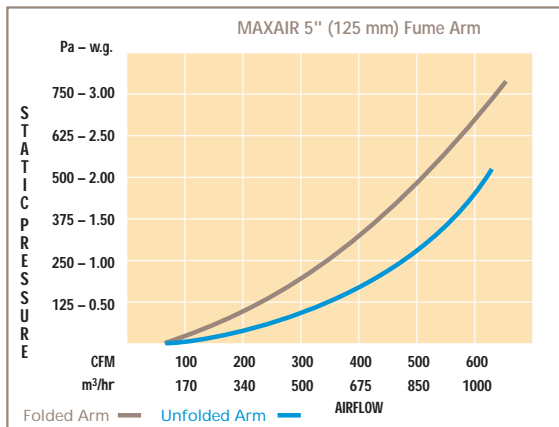
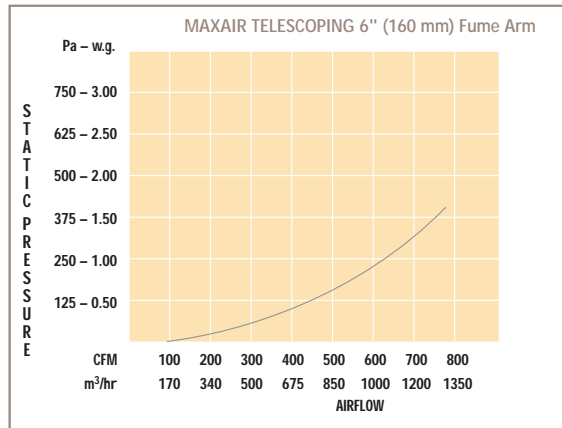
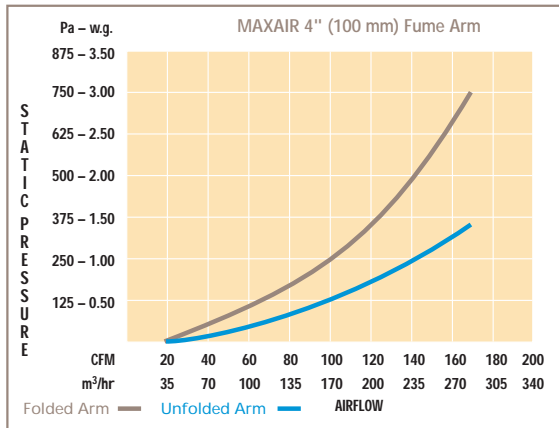
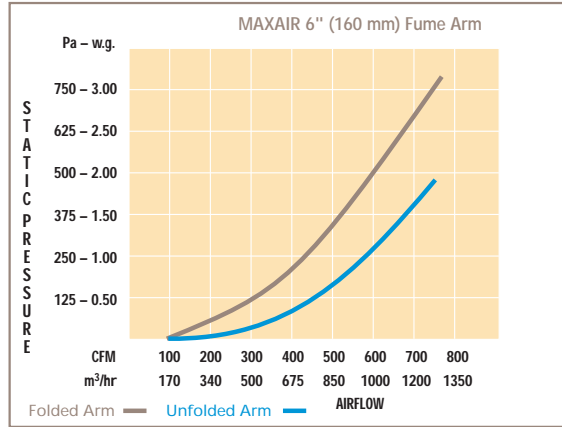
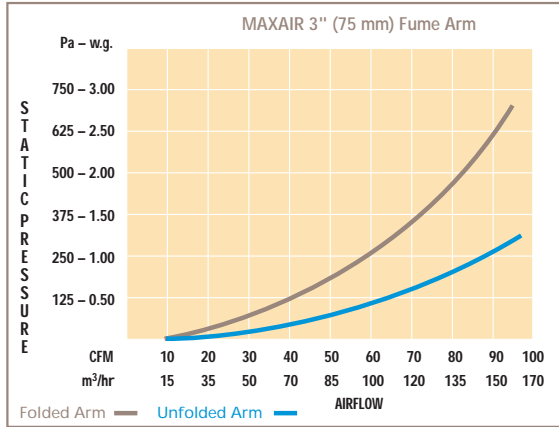

*Superior technology
generating substantial operating savings*

TECHNICAL DATA

Minimum recommended mounting height:

H= 7.1 ft (2.1 m) for the 7'(2 m) arms.
 H= 9.8 ft (2.9 m) for the 10' (3 m) arms.
 H= 10.5ft (3.3 m) for the 14' (4 m) arms.

Bracket below must be ordered separately. Both models (hanging and standing) can be mounted on the bracket. For bracket dimensions, see technical data on this page.

Maxair fume arms mounting flanges:

Arm diameter [inches]	n	d [in.] / [mm]	D1 [in.] / [mm]	D2 [in.] / [mm]	D3 [in.] / [mm]	h [in.] / [mm]
3"	4	.26 / 6.5	2.85 / 72	4.41 / 112	4.92 / 125	.20 / 5
4"	4	.26 / 6.5	3.78 / 94	5.28 / 134	5.83 / 148	.20 / 5
6"	6	.28 / 7	6.02 / 153	7.68 / 195	8.66 / 220	.26 / 7
8"	8	.35 / 9	7.79 / 198	9.68 / 246	10.83 / 275	.35 / 9

Arm wall mounting bracket

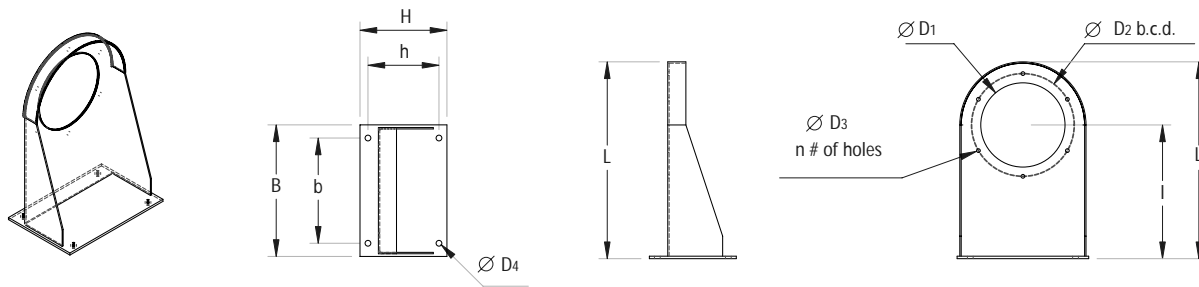

Bracket type	Dimensions [inches] / [mm]												
	øD1	øD2	n	øD3	øD4	L	I	H	h	B	b	i	weight lb / [kg]
WBA-003	3.15 / 80	4.41 / 112	4	0.28/7	0.32/8.2	6.69/170	3.54/90	3.94/100	2.76/70	5.43/138	4.25/108	-	1/45
WBA-004	3.94 / 100	5.28 / 134	4	0.28/7	0.32/8.2	7.48/190	3.94/100	3.94/100	2.76/70	6.30/160	5.12/130	-	1/45
WBA-006	6.30 / 160	7.68 / 195	6	0.28/7	0.43/11	14.72/374	10.00/254	6.50/165	5.31/135	9.84/250	7.87/200	1.38/35	8/3.6
WBA-008	8.07 / 205	9.69 / 246	8	0.35/9	0.43/11	18.11/460	12.36/314	9.84/250	8.27/210	12.99/330	11.42/290	1.57/40	14/6.3

Options

- Light kits
- Fan and light control on the hood
- High temperature or F.D.A. hose at joints
- Fan mounted above arm bracket
- Larger or custom inlet hoods
- Custom colors (minimum quantities required)



To obtain a free copy of our full-colour corporate brochure, please call : 1-866-629-4356
 P.O. Box 72031, Bois-des-Filion, Qc, Canada J6Z 4T7
 Tel.: 1-866-629-4356 / Fax: (450) 621-6677
 Web site: www.aqcdust.com / e-mail: info@aqcdust.com